

VAR 5°W 2018
ANNUAL CHANGE 0.09°W

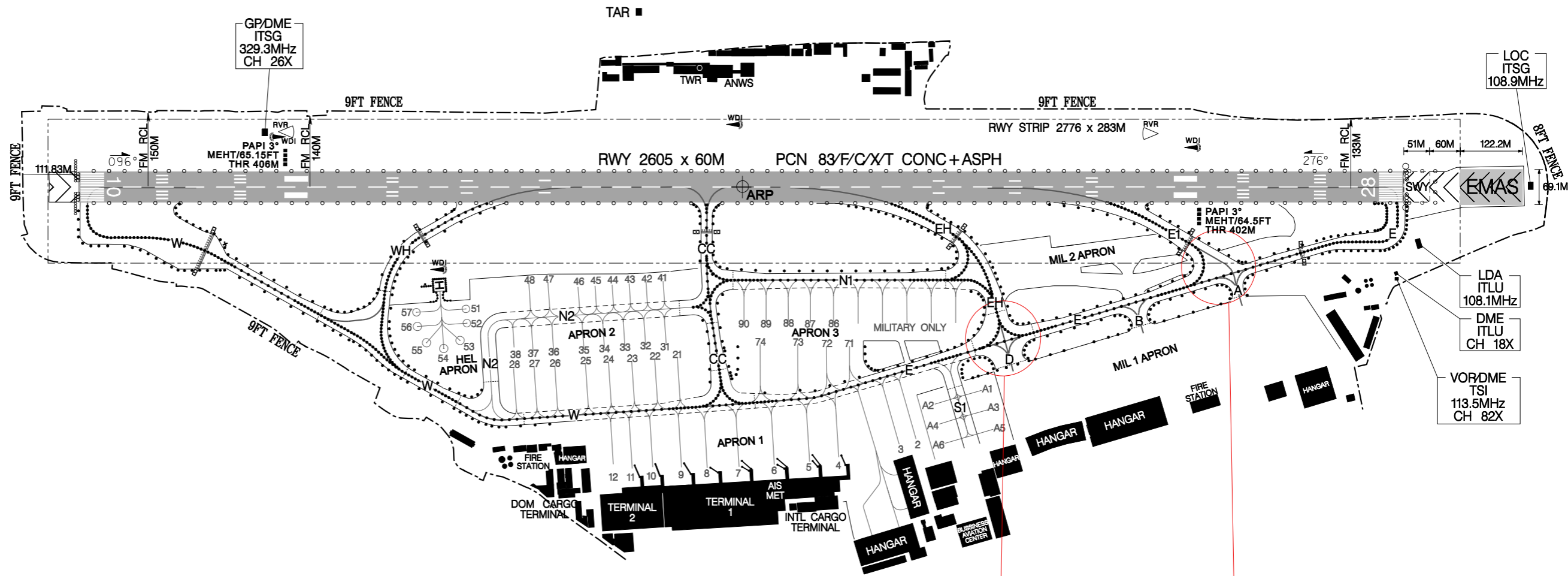

HOT SPOT 1
Exiting RWY 10 onto TWY E1,
Civil ACFT shall turn right to
TWY E. Do not taxi straight
ahead onto TWY A and military
apron (MIL).

HOT SPOT 2
Exiting RWY 10 onto TWY EH,
Civil ACFT shall pay attention to
the taxiing route. Do not taxi straight
ahead onto TWY D and military
apron (MIL).

| RADIO | RWY | THR COORD | THR ELEV | HIGHEST ELEV OF TDZ | GUND | HELICOPTER LANDING AREA | COORD of appropriate TWY Center line points |
|---------------------------|-----|-------------|----------|---------------------|------|-------------------------------|---|
| ATIS: 127.4 | 10 | 250412.18N | 13FT | 13FT | 67FT | HELIPAD ELEV: 12FT | Refer to table on verso of this chart |
| TWR: 118.1 SONGSHAN TOWER | | 1213222.64E | | | | | |
| 121.9 SONGSHAN GROUND | 28 | 250408.89N | 14FT | 17FT | 67FT | Coordinates: 250405N 1213248E | |
| 121.2 SONGSHAN DELIVERY | | 1213355.53E | | | | | |

REV: MAG VAR